

## DDQ 60

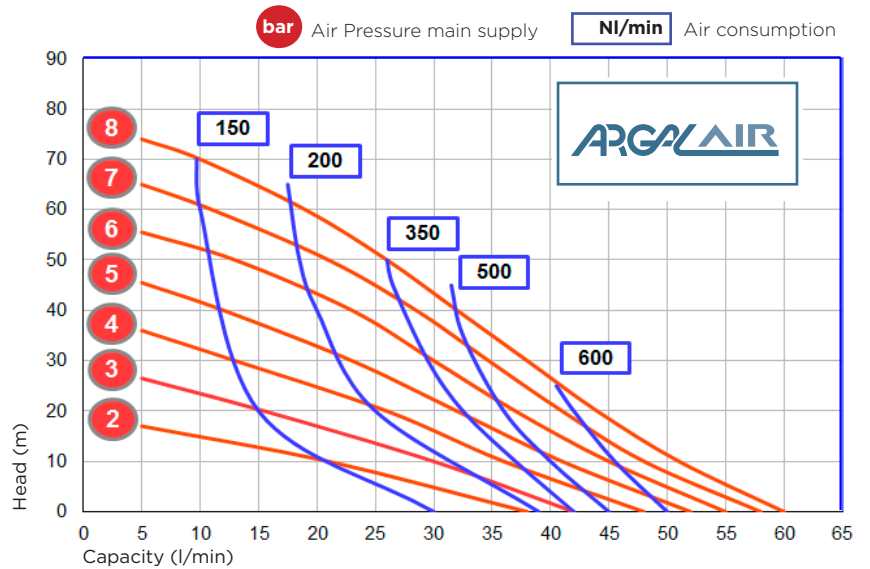

## DDQ 160

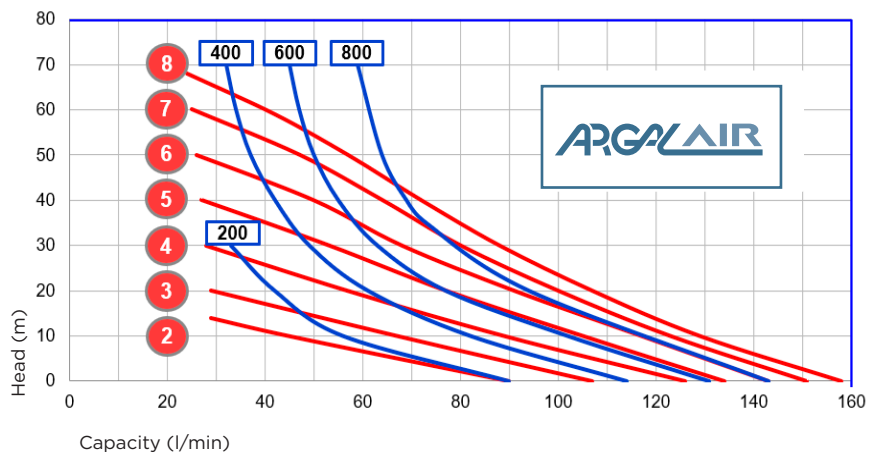

## DDQ 400

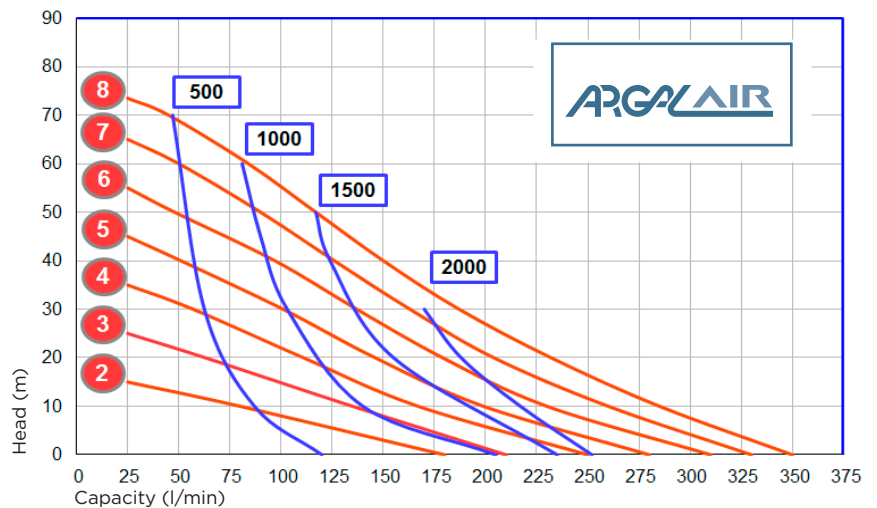

## TECHNICAL DATA

### DDQ 60 • DDQ 160 • DDQ 400

<b>Fluid inlet</b>	G ½" BSP
<b>Air inlet</b>	G ¼" BSP
<b>Max flow rate</b>	60 l/m'
<b>Max working pressure</b>	8 bar
<b>Delivery head</b>	80 mca
<b>Max suction lift dry</b>	4 mca
<b>Max suction lift wet</b>	9 mca
<b>Max solids size</b>	7,5 mm
<b>Noise</b>	78 dB(A)
<b>Weight</b>	6,8 kg (UPPE)   9,9 kg (PTFE)

DIMENSIONS (mm)	
<b>DDQ 60</b>	<b>A 220 B 210 C 186</b>

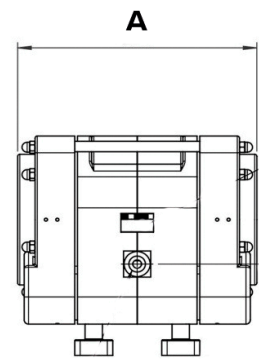
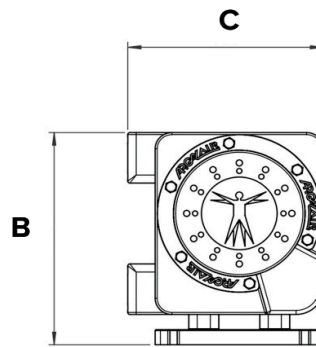

<b>Fluid inlet</b>	G 1" BSP
<b>Air inlet</b>	G ¾" BSP
<b>Max flow rate</b>	160 l/m'
<b>Max working pressure</b>	8 bar
<b>Delivery head</b>	80 mca
<b>Max suction lift dry</b>	4 mca
<b>Max suction lift wet</b>	9 mca
<b>Max solids size</b>	11 mm
<b>Noise</b>	80 dB(A)
<b>Weight</b>	11,7 kg (UPPE)   18,5 kg (PTFE)

DIMENSIONS (mm)	
<b>DDQ 160</b>	<b>A 270 B 250 C 227</b>

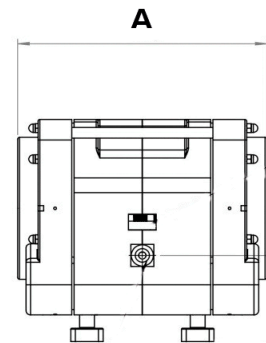
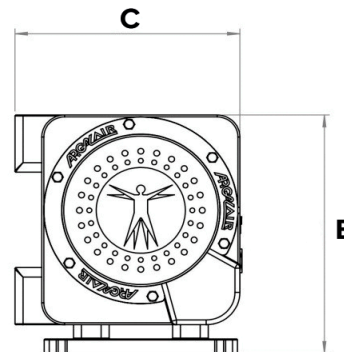

<b>Fluid inlet</b>	G 1 ½" BSP
<b>Air inlet</b>	G ½" BSP
<b>Max flow rate</b>	400 l/m'
<b>Max working pressure</b>	8 bar
<b>Delivery head</b>	80 mca
<b>Max suction lift dry</b>	4 mca
<b>Max suction lift wet</b>	9 mca
<b>Max solids size</b>	19 mm
<b>Noise</b>	83 dB(A)
<b>Weight</b>	27,5 kg (UPPE)   43,5 kg (PTFE)

DIMENSIONS (mm)	
<b>DDQ 400</b>	<b>A 381 B 330 C 310</b>

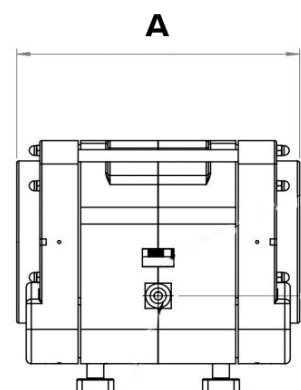
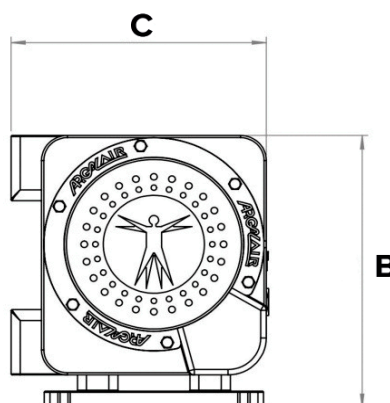

## QUANTUM'S PLUS

### INNOVATIVE COMPONENTS



#### DOUBLE DIAPHRAGM

The QUANTUM pumps construction also included free-fastening diaphragms. This allows easy maintenance, more safety while pumping aggressive liquids and important reduction of air consumption.



#### VALVES

It's possible to disassemble the valves for maintenance without disassembling the entire pump already onsite.

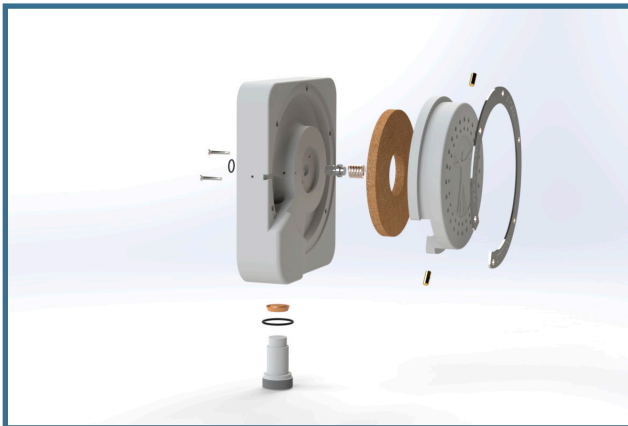

#### FREE ICE FORMATION SYSTEM

It is known that AODD pumps are usually suffering from ice formation in the distribution system. The QUANTUM pumps are an innovative solution allowing to redirect exhausted air, at low temperature, towards the discharge chamber. Thanks to this, the PADS is utterly insensitive to humidity in the air, so there is no influence on the efficiency.

#### DISCHARGE SYSTEM

QUANTUM's DDQ 1" and DDQ 1 1/2" models are equipped with internal pipes to remove the liquid from the pump entirely: an efficient and accurate way for improving the operativity and functionality of the pump.

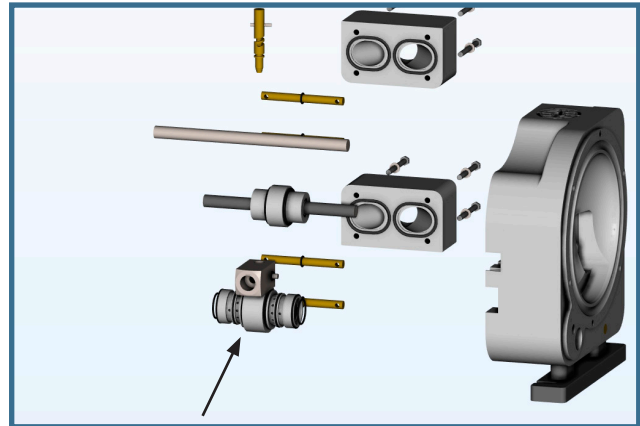

#### SMART PADS

A new simple, compact and highly efficient air distribution system was conceived. It is equipped with an air capacity regulator - without interfering with the pressure used in the control units.

Thanks to the quick discharge valve, a considerable air consumption reduction is noted (up to -30%).

The QUANTUM pumps can, therefore, operate in any work condition.

#### SECURITY SYSTEM

In addition to the longer life cycle, QUANTUM also offers a great advantage: the pump guarantees a major security for operators and the pump itself. The innovation is that, if the diaphragm broke, the pumped liquid would not return to the air supply line.